

TMAX 300HD



CE EN60974-7

CODE	↔	
------	---	--

MA6275	3 m	10'	
MA6276	4 m	12'	
MA6277	4,6 m	15'	

MA6270T	3 m	10'	
MA6271T	4 m	12'	
MA6272T	4,6 m	15'	

MA6270M	3 m	10'	
MA6271M	4 m	12'	
MA6272M	4,6 m	15'	

MA6270L	3 m	10'	
MA6271L	4 m	12'	
MA6272L	4,6 m	15'	

CODE	↔	
------	---	--

MA6270	3 m	10'	
MA6271	4 m	12'	
MA6272	4,6 m	15'	

+	
AR0170	Tweco® 1/4 KIT
AR0172	Lincoln® KIT
AR0173	Miller® KIT
KIT to be assembled by a qualified technician	

TECHNICAL DATA		
----------------	--	--

	0,9 kg	1.98 lb
V PEAK	113	
	0,8 ÷ 1,2 mm	.030" ÷ 0,45"
X 60%	300A CO2 - 250A Mix	

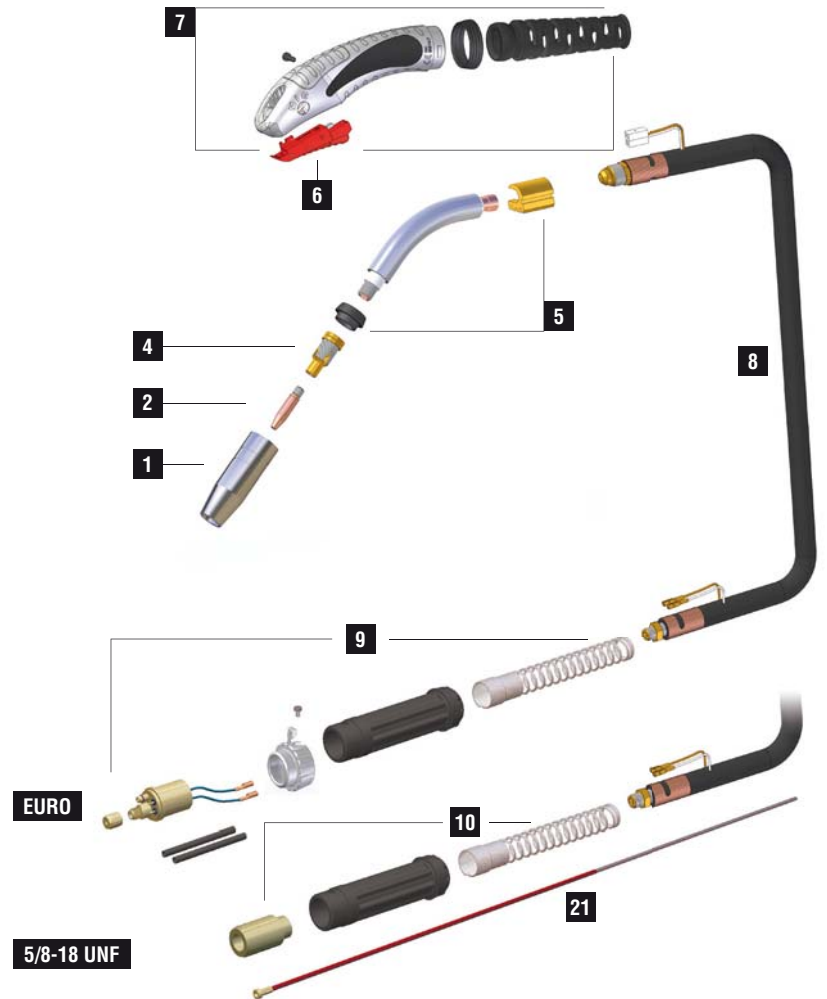

	CODE			Ø		↔	REF	
1	MC0008		MAXI 250 Spare Parts Compatibles	11 mm		71 mm	-	5
1	MC0009		MAXI 250 Spare Parts Compatibles	14 mm		71 mm	-	5
1	MC0010		MAXI 250 Spare Parts Compatibles	18 mm		71 mm	-	5
1	MC0128			16 mm	5/8"	71 mm	-	5
1	MC0129			14 mm		71 mm	-	5
2	MD0300-08		M7 - Cu	0,8 mm	.030"	36 mm	-	20
2	MD0300-09		M7 - Cu	0,9 mm	.035"	36 mm	-	20
2	MD0300-10		M7 - Cu	1,0 mm	.040"	36 mm	-	20
2	MD0300-12		M7 - Cu	1,2 mm	.045"	36 mm	-	20
2	MD0300-14		M7 - Cu	1,4 mm	.052"	36 mm	-	20
2	MD0300-16		M7 - Cu	1,6 mm	1/16"	36 mm	-	20
4	ME0369		M7 - brass TMAX 300 HD			33 mm	-	5
21	GM0012		red steel liner	1,0 ÷ 1,2 mm	.040" ÷ .045"	5 m	16.4'	42-4045-15 1

	CODE		
5	FB0653		
5	MF0369		mig torch head 1
5	MQ0341		
6	BX0742		trigger
7	MT0260		handle kit
8	MH0470		3 m - 10' - 35 mm ²
8	MH0471		4 m - 12' - 35 mm ²

	CODE		
8	MH0472		4,6 m - 15' - 35 mm ²
9	AR0083		EURO TW
9	BW0480		Euro nut
9	FA0027		liner nut M11X1
9	MT0229		Back box kit euro 1
10	FB0395		5/8-18 UNF
10	MT0228		Back box kit 5/8-18 UNF 1

	CODE	TMAX 300		
4	ME0366		M7 - brass tmax 300	5

STANDARD

FOR ALL CONSUMABLES SEE PAGE 294